



THE WASHINGTON STATE BOARD OF EDUCATION

An education system where students are engaged in personalized education pathways that prepare them for civic engagement, careers, postsecondary education, and lifelong learning

COMMITTEE AND OTHER UPDATES

Prepared for the May 2019 Board Meeting

Information and possible action item.

As related to:

Goal One: All students feel safe at school, and have the supports necessary to thrive.

Goal Two: All students are able to engage in their schools and their broader communities, and feel invested in their learning pathways, which lead to their post-secondary aspirations.

Goal Three: School and district structures and systems adapt to meet the evolving needs of the student population and community, as a whole. Students are prepared to adapt as needed and fully participate in the world beyond the classroom.

Goal Four: Students successfully transition into, through, and out of the P-12 system.

Goal Five: Students graduate from Washington State high schools ready for civic engagement, careers, postsecondary education, and lifelong learning.

Goal Six: Equitable funding across the state to ensure that all students have the funding and opportunities they need, regardless of their geographical location or other needs.

Other

Materials:

1. Student Voice Committee Charter
2. Agendas from NASBE SEL and ECE meetings

Synopsis and Policy considerations:

SBE members who attended the NASBE Legislative Conference, Social and Emotional Learning Network, and Early Learning Educator Leadership Network meeting will report out about those meetings. Agendas from the NASBE SEL and ECE meetings are included, and other key documents related to those meetings are: <https://drive.google.com/drive/folders/1hIU98fz9uO0yWuLCazH3XO8sIKhQBhJx> and <http://nationathope.org/report-from-the-nation/executive-summary/>

Board Committees will update the full Board on recent discussions and upcoming events, including a report from the newly formed student voice committee and a discussion with the Equity committee members about the next equity summit.

2019 NASBE Early Childhood Education State Network Meeting

April 9, 2019

The Madison Hotel (1177 15th St NW, Washington, DC 20005)

Room: Montpelier A

Meeting Goals:

- Discussion trends and issues in Early Learning with state teams and national experts
- Provide states with resources that can inspire new ideas and strategies to further define goals and activities
- Provide peer learning opportunities for states to share best practices and lessons learned

7:00 – 8:30 a.m. Registration

7:00 – 8:00 a.m. Breakfast and Networking (Room: Mount Vernon)

8:00 – 8:40 a.m. Welcome and Introduction

Participants will get to know each other professionally and maybe personally. People will reflect on how they have gotten to the meeting.

- **Winona Hao**, Director of Early Learning, NASBE
- **Rebecca Cohen**, Vice President, Advocacy & Communication Solutions (ACS)

8:40 – 9:10 a.m. Opening Remarks: *Why the K-12 World Hasn't Embraced the Early Learning*

This session will explore the relationship between K-12 education and early education. For years, the K-12 world has fundamentally underappreciated how the early years shape long-term educational outcomes. In both the K-12 and early learning worlds, there has been a corollary underestimation of the many ways policy and culture enforce a separation between the two.

- **Elliot Regenstein**, Partner, Foresight Law + Policy

9:10 – 10:10 a.m. Q&A and State Reflections

- **Elliot Regenstein**, Partner, Foresight Law + Policy
- **Winona Hao**, Director of Early Learning, NASBE (Facilitator)
- **Rebecca Cohen**, Vice President, ACS (Facilitator)

10:10 – 10:20 a.m. National partner report (New America+ Education Commission of States)

10:20 – 10:30 a.m. Break

- 10:30 – 11:20 a.m.** **Now you have a 3rd Grade Reading Law, What’s Next? — Review of and promising practices in state early literacy policies.**
This session will review and discuss the promising practices across all states that increase student achievement and highlight the policy indicators that are key to success.
- **Matt Weyer, PhD**, Senior Policy Specialist, Education Program
National Conference of State Legislatures
 - **Bonnie O’Keefe**, Associate Partner, Bellwether Education Partners
 - **Remarks from CELO.**
- 11:20 – 12:00 p.m.** **Table Discussions on Early Literacy Policies**
- **Rebecca Cohen**, Vice President, ACS (Moderator)
- 12:00 – 1:00 p.m.** **Joint Lunch with Social Emotional Learning Network (Room: Mount Vernon)**
- 1:00 – 2:00 p.m.** **States Share and Update**
State representatives will share their progress through NASBE ECE network. States will do a quick overview of their efforts and then they will discuss some challenges and opportunities along the way and their future planning.
- 2:00 – 2:30 p.m.** **Preschool Development Grant and Federal Funding Landscape**
Richard Gonzales, Director, Division of Interagency & Special Initiatives, DHHS/
Administration for Children and Families, Office of Child Care
- 2:30 – 3:00 p.m.** **State Reaction and Wrap Up**

Social and Emotional Learning Network In-Person Meeting

The Madison, 1177 15th Street NW, Washington, DC 20005
Room Montpelier-B

AGENDA: Tuesday, April 9, 2019

- 7:00 – 8:00 am** **Registration, Breakfast, and Optional Team Meeting Time**
Meal and beverage service will be provided.
- 8:00 – 8:15 am** **Welcome**
Overview of day and round robin of introductions.

Speaker: **Megan Blanco**, Senior Policy Associate, NASBE
- 8:15 – 9:15 am** **State Team Updates**
Network states will make a presentation on the progress made since the October 2018 Network convening, their short-term and long-term goals, barriers/challenges to their work, and strategies to mitigate these barriers.
- 9:15 – 9:30 am** **Break**
Beverage service will be provided.
- 9:30 – 10:15 am** **Federal Activity Around SEL**
Federal agency partners will have a roundtable discussion with state teams about their agency programs, funding opportunities, or initiatives that enable states to provide SEL and answer questions about their work.

Speakers: **Lisa Bishop**, Senior Advisor for Education Initiatives, Corporation for National and Community Service
 Leigh Szucs, Health Scientist, Division of Adolescent and School Health, U.S. Centers for Disease Control and Prevention
 Kelly Terpak, Director of Evidence-Based Practice, Office of Elementary and Secondary Education, U.S. Department of Education
- 10:15 – 10:45 am** **National Partner Updates**
National partners will update attendees on their organizations' current initiatives, upcoming activities, and available resources to support SEL policy development at the state level.

Speakers: **Anne Bowles**, Program Director, Student-Centered Learning, CCSSO
 Shanna Shipman, Technical Consultant, American Institutes for Research
 Nick Yoder, Director of Policy and Practice, CASEL
- 10:45 – 12:15 pm** **Culturally Responsive Policymaking™**
Attendees will build their capacity to address educational inequities in their states, promote equitable, safe, and supportive learning environments, and consider issues of race and culture in an SEL context

Speaker: **Kimberly Charis**, Director of School Climate, Discipline, & Equity, NASBE

12:15 – 1:00 pm

Lunch and Optional Team Meeting Time

Meal and beverage service will be provided.

1:00 – 3:30 pm

Being an Effective Communicator for SEL in Your State

Edge Research will present the research findings from the SEL Network 5-state survey and facilitate a discussion on applying these findings.

Speakers:

Pam Loeb, Principal, Edge Research

Stacia Tipton, Senior Research Analyst, Edge Research

3:30 – 4:00 pm

Wrap-up & Looking Ahead

Network teams will discuss meeting takings and next steps for advancing towards achieving their short-term and long-term SEL goals.

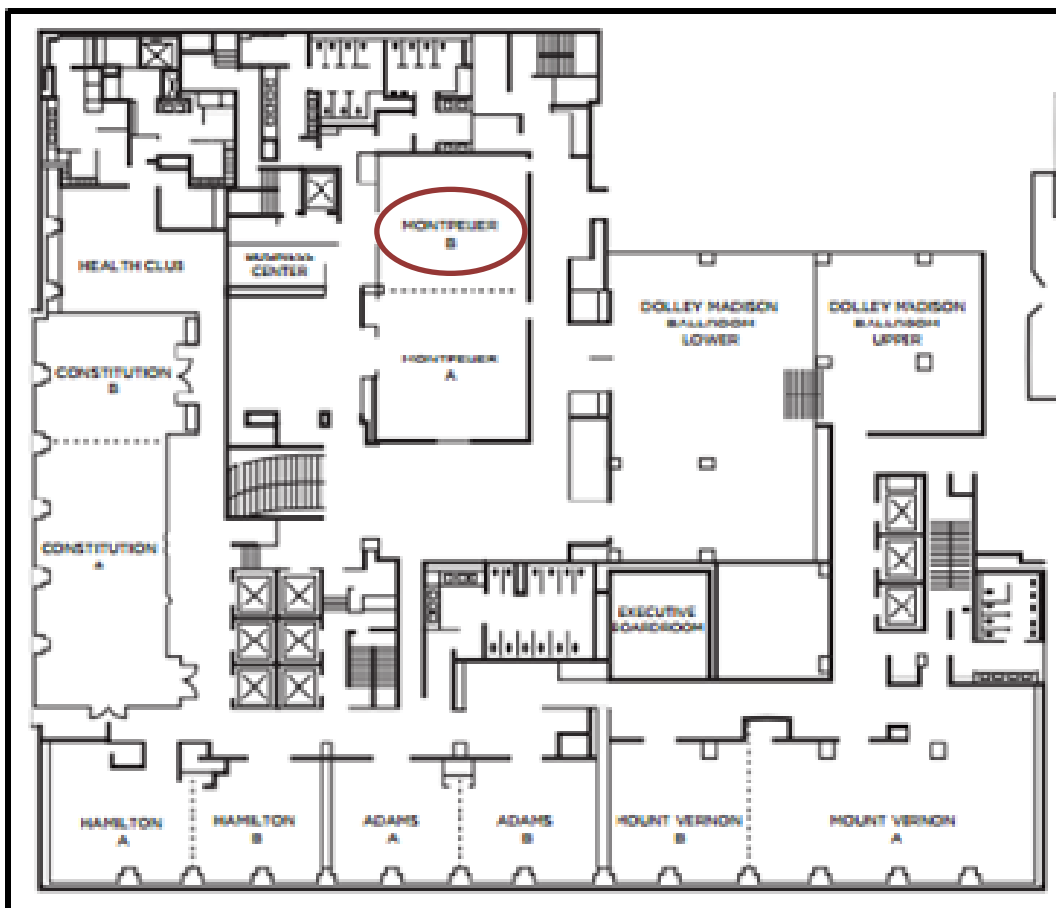



THE WASHINGTON STATE BOARD OF EDUCATION

An education system where students are engaged in personalized education pathways that prepare them for civic engagement, careers, postsecondary education, and lifelong learning

STUDENT VOICE COMMITTEE CHARTER

Purpose

The purpose of the Student Voice Committee of the State Board of Education is to ensure student Board members have a meaningful, productive, and impactful experience as representatives of their peers.

Strategies

The committee serves as a sounding board and resource for student Board members to:

- work in collaboration with other Board members to highlight issues of importance to students in our educational system;
- ensure student perspectives are heard on issues and policy proposals being developed or considered by the Board;
- maximize potential in leveraging student voice in advocacy as student representatives and as peer leaders;
- seek feedback from their peers and utilize student voice on issues of importance to Washington students;
- develop relationships and network with local educators, elected officials and student peers as it relates to both policy and advocacy; and
- support the onboarding process of new student board members to help them understand their role on the Board, explain essential concepts, and engage with adult mentors.